



**Port Kembla, NSW**  
73 Shellharbour Road

<b>2</b>	<b>1</b>	<b>1</b>
BED	BATH	CAR

**SPACIOUS TWO BEDROOM HOME**

Welcome to this charming two-bedroom home nestled in the scenic Port Kembla, offering a comfortable and spacious living environment.

Upon entry, you're greeted by a warm and inviting atmosphere. The living space is generously sized, providing ample room for relaxation and entertainment. Natural light floods the interior, creating a bright and airy ambiance throughout.

The kitchen boasts ample storage space, ensuring convenience for meal preparation. Adjacent to the kitchen is the dining room, where you can enjoy breathtaking views of the nearby lake while indulging in delicious meals with loved ones.

This home features two well-appointed bedrooms, each offering comfort and privacy for peaceful rest. Oversized main bathroom.

Outside, the property boasts a spacious backyard, perfect for outdoor activities and gatherings. A cubby house adds a touch of whimsy for children, while a large shed provides ample storage space for tools and equipment added convenience of a second toilet. Multiple covered areas offer shelter from the elements, allowing for year-round enjoyment of the

outdoors.

Conveniently, a carport with roller door access provides secure parking for vehicles, ensuring peace of mind for residents.

This delightful home is offered partly furnished, allowing for easy transition and immediate enjoyment of its many comforts. Whether you're seeking a peaceful retreat or a place to entertain guests, this property offers the perfect blend of comfort, convenience, and stunning views in the heart of Port Kembla.

**\$560 pw**

**Contact:** Zoe Porritt  
0456 937 843  
Jye Sanjurjo  
0402 803 830

**Type:** House

**Date Available:** 12/03/2024

**Bond:** \$2240

**<https://www.spinellirealestate.com.au>**

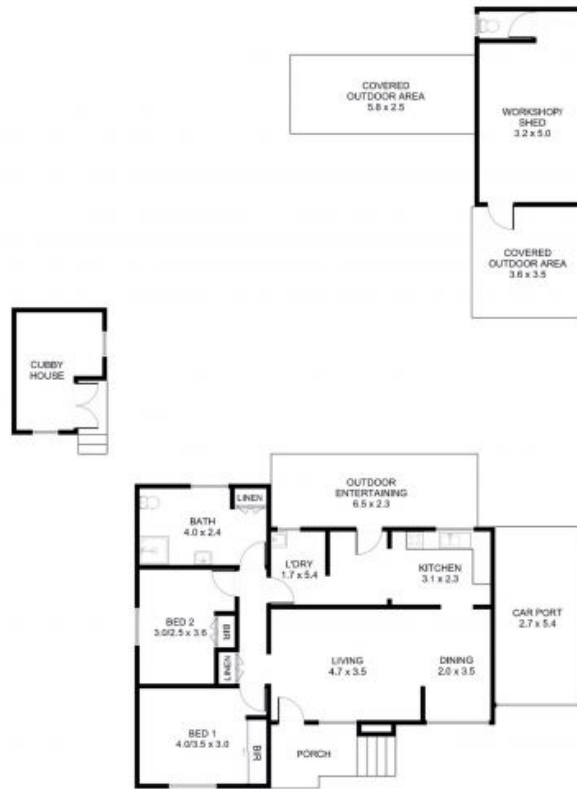

DISCLAIMER Spinelli Real Estate used the best endeavours to make the information on this floorplan accurate and true. Unit areas if shown are approximate only. Spinelli Real Estate do not guarantee or warrant the accuracy or correctness of any information or statement contained in the above floor plan. Buyers should not rely on this floorplan as indicating the final design, appearance, content or as constructed format of the building. Buyers must make and rely on their own enquiries and should obtain advice in making any decision based on the information contained herein.



Plans shown are only indicative of layout. Dimensions are approximate.

**Port Kembla, NSW**  
73 Shellharbour Road

**Zoe Porritt**  
0456 937 843

**Jye Sanjurjo**  
0402 803 830