



## Shellharbour, NSW

82a Darley Street

**3**  
BED

**2**  
BATH

**2**  
CAR

### NEAR NEW TOWNHOUSE

Welcome to this near-new, exquisite three-bedroom townhouse nestled in the heart of Shellharbour Village, offering the ultimate coastal lifestyle. Perfectly situated within walking distance to the picturesque Shellharbour Marina and pristine beach, this property presents a rare opportunity to live in a sought-after location.

Tenants have the option to choose between a fully furnished or unfurnished arrangement, allowing you to tailor the property to your personal style and preferences. Lease period is negotiable, preferably long term.

You will be captivated by the open plan living design that seamlessly flows through to the generously sized covered outdoor entertaining area provides an idyllic space to relax, dine, and entertain, while enjoying the fresh coastal breeze.

**\$760 pw**

**Contact:** Zoe Porritt  
0456 937 843  
Jye Sanjurjo  
0402 803 830

**Type:** Townhouse

**Date Available:** 05/05/2024

<https://www.spinellirealestate.com.au>

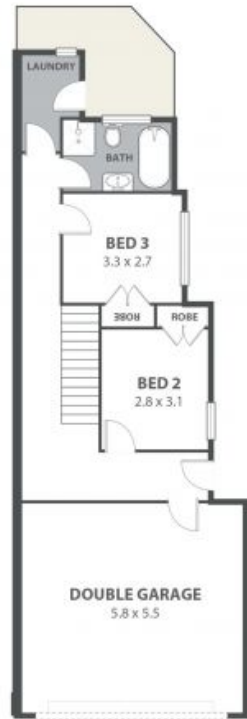

LOWER LEVEL



UPPER LEVEL

DISCLAIMER Spinelli Real Estate used the best endeavours to make the information on this floorplan accurate and true. Unit areas if shown are approximate only. Spinelli Real Estate do not guarantee or warrant the accuracy or correctness of any information or statement contained in the above floor plan. Buyers should not rely on this floorplan as indicating the final design, appearance, content or as constructed format of the building. Buyers must make and rely on their own enquiries and should obtain advice in making any decision based on the information contained herein.

**SPINELLI**   
REAL ESTATE

Plans shown are only indicative of layout. Dimensions are approximate.

**Shellharbour, NSW**  
82a Darley Street

**Zoe Porritt**  
0456 937 843

**Jye Sanjurjo**  
0402 803 830