



**Farmborough Heights, NSW**  
30 Fairloch Avenue

**3** **2** **1**  
BED BATH CAR

**A PIECE OF PARADISE**

You cant help but fall in love with this federation style home that oozes with character in a quiet sought after area. It features a large rumpus/teenage retreat which adjoins a private undercover entertainment area. Features polished timber floorboards, Tasmanian oak timber kitchen, gas cooking, gas heating, wrap around verandah, split system air con, 2 toilets, all bedrooms with BIW's, a lock-up garage with a workshop. Well appointed landscaped gardens with a cubby house for the kids. Definitely worth an inspection.

**Contact:** Paul Spinelli  
0415 112 702  
**Type:** House  
**Sold Date:** 21/07/2015  
**Land:** 607Square Metres  
<https://www.spinellirealestate.com.au>



GROUND FLOOR

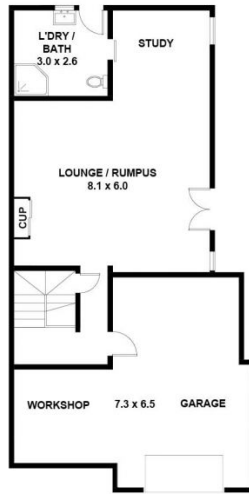

FIRST FLOOR



**30 Fairloch Ave Farmborough Heights**  
 Residence Area: 90m<sup>2</sup> (approx. internal area)

DISCLAIMER: Origin Photography used the best endeavours to make the information on this floorplan accurate and true. Unit areas shown are approximate only. Buyers must make and rely on their own enquiries and should obtain advice in making any decision based on the information contained on this plan.

Plans shown are only indicative of layout. Dimensions are approximate.

**Farmborough Heights, NSW** Paul Spinelli  
 30 Fairloch Avenue 0415 112 702